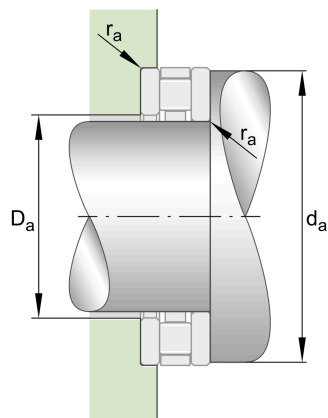
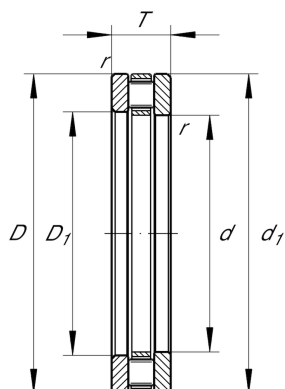
**81102-TV**

Axial cylindrical roller bearing

Schaeffler ID:
0002402490000Axial cylindrical roller bearings 811, single
direction, comprising K811, GS, WS

Technical information

**Main Dimensions & Performance Data**

d	15 mm	Bore diameter
D	28 mm	Outside diameter
T	9 mm	Height
C_a	14,400 N	Basic dynamic load rating, axial
C_{0a}	28,500 N	Basic static load rating, axial
C_{ua}	4,050 N	Fatigue load limit, axial
n_G	13,400 1/min	Limiting speed
n_{gr}	6,300 1/min	Reference speed
	21.3 g	Weight

Additional information

	K81102-TV	Axial roller and cage assembly
D_1	16 mm	Bore diameter housing washer
	GS81102	Housing Washer
d_1	28 mm	Rip diameter shaft washer
	WS81102	Shaft washer
	LS1528	Track Washer
r_{min}	0.3 mm	Minimum chamfer dimension

Mounting dimensions

$d_{a min}$	27 mm	Minimum diameter shaft shoulder
$D_{a max}$	16 mm	Maximum diameter of housing shoulder
$r_{a max}$	0.3 mm	Maximum recess radius

Temperature range

T_{min}	120 °C	Operating temperature min.
T_{max}	-30 °C	Operating temperature max.